

Bread - SH Non-Refrigerated Shelving Case

Models

SHS2465A.5668
 SHS3665A.5668
 SHS6065A.5668
 SHS7265A.5668



Features	Standard	Options
EXTERIOR COLOR	<input type="checkbox"/> Laminated (Huntington Maple)	
INTERIOR COLOR	<input type="checkbox"/> Caramel Sagawood	
TRIM COLOR	<input type="checkbox"/> Silver	
BASE	<input type="checkbox"/> Straight base	
BASE SUPPORT	<input type="checkbox"/> Levelers	
BUMPER	<input type="checkbox"/> 3" bumper on front (Brown)	<input type="checkbox"/> 3" bumper on front & left end (Brown) <input type="checkbox"/> 3" bumper on front & right end (Brown)
DECK	<input type="checkbox"/> Convertible from flat to angled	
END PANELS	<input type="checkbox"/> None (specify per line-up)	<input type="checkbox"/> Cutaway end panel
HEADER	<input type="checkbox"/> Flat	
UPPER REAR	<input type="checkbox"/> Solid upper back panel	
SHELF PRODUCT RETAINER	<input type="checkbox"/> Side product retainers	
SHELVING	<input type="checkbox"/> Laminated (Huntington Maple) shelves (1) 18"D, (2) 22"D & (1) 28"D	
LIGHTS	<input type="checkbox"/> LED shelf lights	

Applications

- Upright Multi-shelf self-serve merchandiser for non-refrigerated packaged bakery items

Bread SH Non-Refrigerated Shelving Case

Model	L x D x H (Lengths do not include 3/4" end panels)
SHS2465A.5668	24"L x 36-7/8"D x 64-1/4"H
SHS3665A.5668	36"L x 36-7/8"D x 64-1/4"H
SHS6065A.5668	60"L x 36-7/8"D x 64-1/4"H
SHS7265A.5668	72"L x 36-7/8"D x 64-1/4"H

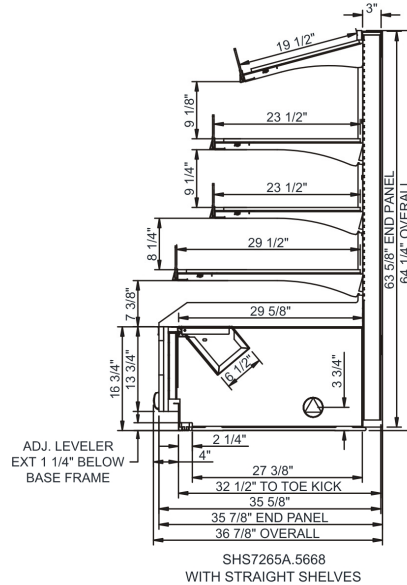
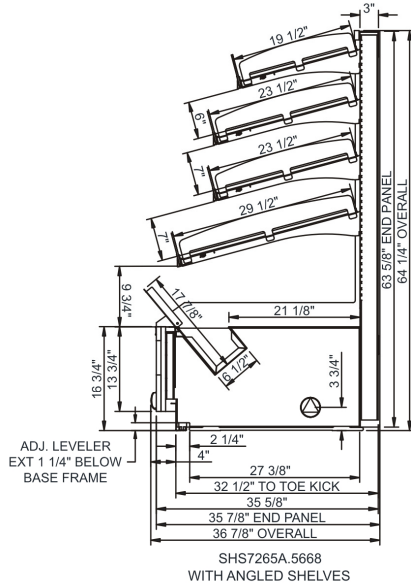

IMPORTANT NOTES:

1) Units are supplied with levelers which must be adjusted during installation to ensure the unit is level and plumb.



WARNING:

This product can expose you to chemicals, including Urethane (Ethyl Carbamate), which are known to the state of California to cause cancer and birth defects or other reproductive harm. For more information go to www.P65Warnings.ca.gov.

INTENDED ENVIRONMENT

Designed to operate in ambient conditions of 75°F with 55% relative humidity.

WARMEST AVG PRODUCT TEMP

Zone	Temp (°F)
1	Ambient

INTENDED USE OF DISPLAY AREAS

Zone	Intended Use
1	Packaged non-refrigerated products

For more information on any of our products or services please visit us on the web at:

www.structuralconcepts.com

INFORMATION IS SUBJECT TO CHANGE WITHOUT NOTICE. Visit www.structuralconcepts.com for the most current specs.



888 E. Porter Rd. Muskegon, MI 49441

231-798-8888

Revised 8/8/2019