

Bread - Bread Shelving Stick Base 30° Wedge Case

Models
SHSW3065

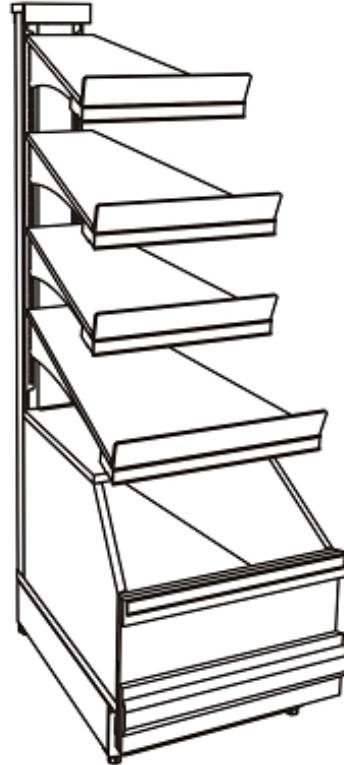

Features	Standard	Options
EXTERIOR COLOR	<input type="checkbox"/> Laminated (Caramel Sagawood)	
INTERIOR COLOR	<input type="checkbox"/> Stardust silver	
BASE	<input type="checkbox"/> Straight base	
BASE SUPPORT	<input type="checkbox"/> Levelers	
BUMPER	<input type="checkbox"/> 3" bumper on front & ends (Brown)	<input type="checkbox"/> 3" bumper on front & left end (Brown) <input type="checkbox"/> 3" bumper on front & right end (Brown) <input type="checkbox"/> 3" bumper on front (Brown)
END PANEL LEFT	<input type="checkbox"/> No end panel (for same case to case connect)	<input type="checkbox"/> Cutaway end panel
END PANEL RIGHT	<input type="checkbox"/> No end panel (for same case to case connect)	<input type="checkbox"/> Cutaway end panel
HEADER STYLE	<input type="checkbox"/> Flat header	
UPPER REAR	<input type="checkbox"/> Solid back panel	
CRUMB TRAY	<input type="checkbox"/> Removable crumb tray on each shelf	
SHELF PRODUCT STOP	<input type="checkbox"/> Acrylic product stops w/sign channel	
SHELVING	<input type="checkbox"/> Lighted (LED) laminated (Caramel Sagawood) shelves (1) 20"D, (2) 24"D & (1) 30"D	
LIGHTS	<input type="checkbox"/> LED top & shelf lights	
POWER CORD	<input type="checkbox"/> Leads	

Applications

- Upright multi-shelf self-service wedge merchandiser for non-refrigerated packaged bakery items.

Bread Bread Shelving Stick Base 30° Wedge Case

Model	L x D x H (Lengths do not include 3/4" end panels)
SHSW3065	23-3/4"L x 37-3/8"D x 64-1/4"H

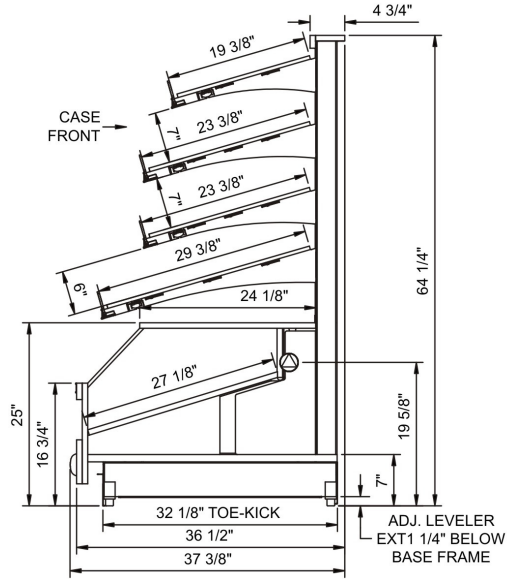

IMPORTANT NOTES:

- 1) 36" Minimum door entry clearance required (Without shipping skid).
- 2) Units are supplied with levelers which must be adjusted during installation to ensure the unit is level and plumb.

INTENDED ENVIRONMENT

Designed to operate in ambient conditions of 75°F with 55% relative humidity.

WARMEST AVG PRODUCT TEMP

Zone	Temp (°F)
All	Ambient

INTENDED USE OF DISPLAY AREAS

Zone	Intended Use
All	Packaged non-refrigerated products

For more information on any of our products or services please visit us on the web at:

www.structuralconcepts.com

INFORMATION IS SUBJECT TO CHANGE WITHOUT NOTICE. Visit www.structuralconcepts.com for the most current specs.



888 E. Porter Rd. Muskegon, MI 49441

231-798-8888

Revised 2/26/2018