

Bread - Base Wall Case (For Refrigerator)

Models

BC2465.5059



Features	Standard	Options
EXTERIOR COLOR	<input type="checkbox"/> Laminated (Caramel Sagawood)	
FRAME COLOR	<input type="checkbox"/> Stardust silver	
BASE	<input type="checkbox"/> Roll bread base	
BASE SUPPORT	<input type="checkbox"/> Levelers	
BUMPER	<input type="checkbox"/> 3" bumper on front (Brown)	<input type="checkbox"/> 3" bumper on front & left end (Brown) <input type="checkbox"/> 3" bumper on front & right end (Brown)
HEADER STYLE	<input type="checkbox"/> Flat header	
UPPER REAR	<input type="checkbox"/> Solid back panel	

Applications

- Upright self-service non-refrigerated merchandiser cabinet for holding refrigerator supplied by others.

Bread Base Wall Case (For Refrigerator)

Model	L x D x H (Lengths include end panels)
BC2465.5059	27-3/4"L x 37-3/8"D x 64-1/4"H

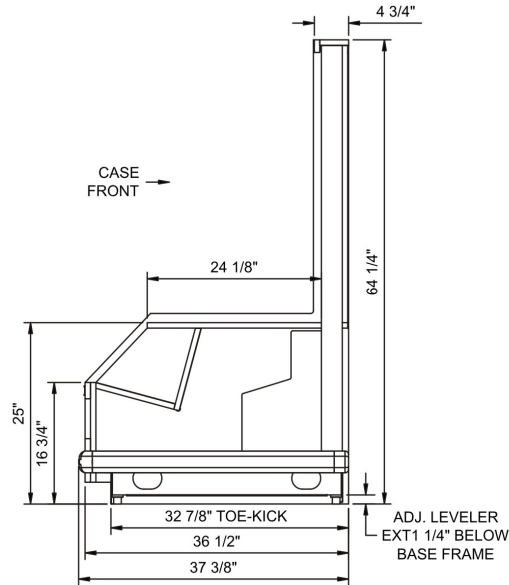

IMPORTANT NOTES:

- 1) 38" Minimum door entry clearance required (Without shipping skid).
- 2) Units are supplied with levelers which must be adjusted during installation to ensure the unit is level and plumb.

INTENDED ENVIRONMENT

Designed to operate in ambient conditions of 75°F with 55% relative humidity.

WARMEST AVG PRODUCT TEMP

Zone	Temp (°F)
All	Ambient

INTENDED USE OF DISPLAY AREAS

Zone	Intended Use
All	Packaged non-refrigerated products

For more information on any of our products or services please visit us on the web at:

www.structuralconcepts.com

INFORMATION IS SUBJECT TO CHANGE WITHOUT NOTICE. Visit www.structuralconcepts.com for the most current specs.



888 E. Porter Rd. Muskegon, MI 49441

231-798-8888

Revised 3/8/2018